

# TWC 400

# AIR-COOLED MIG GUN

Replacement Suitable for Tweco®

RATING	GUN ORDERING PART NUMBER	GUN PLUG Direct Connect
<b>400 Amp CO2 @ 80% Duty Cycle</b>  <b>300 Amp Mixed Gas @ 80% Duty Cycle</b>  <b>Wire Capacity: 0.030" (0.8mm) - 5/64" (2.0mm)</b>	C4xx-3545 CX4xx-3545 CH4xx-3545 CL4xx-3545 CLPM4xx-3545 CLF4xx-3545 CM4xx-3545 CP4xx-3545  <small>xx = Standard lengths of 10, 12, 15, 20 and 25 ft. Custom lengths also available.</small>	<b>Tweco® #4</b> <b>Euro</b> <b>Hobart®</b> <b>Lincoln® "LN"</b> <b>Lincoln® W.M./Power MIG</b> <b>Linc.® LF/DH10/PowerFeed</b> <b>Miller®</b> <b>Panasonic®</b>

#	Part Number	Description	
1.	C24A-50	Nozzle, 1/2" I.D. Adjustable	
	C24A-62	Nozzle, 5/8" I.D. Adjustable, Std.	
	C24A-75	Nozzle, 3/4" I.D. Adjustable	
	C24A-37-SS	Nozzle, 3/8" I.D. Short Stop	
	C24A-50-SS	Nozzle, 1/2" I.D. Short Stop	
	C24A-62-SS	Nozzle, 5/8" I.D. Short Stop	
	C24A-75-SS	Nozzle, 3/4" I.D. Short Stop	
	C24AT-37-SS	Nozzle, Tapered, 3/8" I.D. Short Stop	
	C23-37	Nozzle, Self Insulated, 3/8" I.D.	
	C23-50	Nozzle, Self Insulated, 1/2" I.D.	
	C23-62	Nozzle, Self Insulated, 5/8" I.D.	
	C23-75	Nozzle, Self Insulated, 5/8" I.D.	
	C23T-37	Nozzle, Tapered, Self Insulated, 3/8" I.D.	
	C24CT-37-S	Nozzle, Coarse Thread, 3/8" I.D.	
	C24CT-50-S	Nozzle, Coarse Thread, 1/2" I.D.	
	C24CT-62-S	Nozzle, Coarse Thread, 5/8" I.D.	
	C24CT-75-S	Nozzle, Coarse Thread, 3/4" I.D.	
	2.	C14-30	Contact Tip, .030" 0.8mm
		C14-35	Contact Tip, .035" 0.9mm, Std.
C14-40		Contact Tip, .040" 1.0mm	
C14-45		Contact Tip, .045" 1.2mm	
C14-52		Contact Tip, .052" 1.4mm	
C14-116		Contact Tip, 1/16" 1.6mm	
C14-564		Contact Tip, 5/64" 2.0mm	
C14A-364		Contact Tip, Aluminum, 3/64"	
C14H-35		Contact Tip, H.D., .035" 0.9mm	
C14H-40		Contact Tip, H.D., .040" 1.0mm	
C14H-45		Contact Tip, H.D., .045" 1.2mm	
C14H-52		Contact Tip, H.D., .052" 1.4mm	
C14H-116		Contact Tip, H.D., 1/16" 1.6mm	
C14H-564		Contact Tip, H.D., 5/64" 2.0mm	
C14AH-364		Contact Tip, H.D., Aluminum, 3/64"	
C14AH-116		Contact Tip, H.D., Aluminum, 1/16"	
C14T-30		Contact Tip, Tapered, .030" 0.8mm	
C14T-35		Contact Tip, Tapered, .035" 0.9mm	
C14T-40		Contact Tip, Tapered, .040" 1.0mm	
C14T-45	Contact Tip, Tapered, .045" 1.2mm		
C14T-52	Contact Tip, Tapered, .052" 1.4mm		
C14T-116	Contact Tip, Tapered, 1/16" 1.6mm		
3.	C34A	Nozzle Insulator	
	C54A	Gas Diffuser, Std.	
	C34CT	Nozzle Insulator	
6.	C64J-45	Conductor Tube, Jacketed, 45°	
	C64J-60	Conductor Tube, Jacketed, 60°, Std.	
	C64J-80	Conductor Tube, Jacketed, 80°	
	C64J-180	Conductor Tube, Jacketed, 180°	

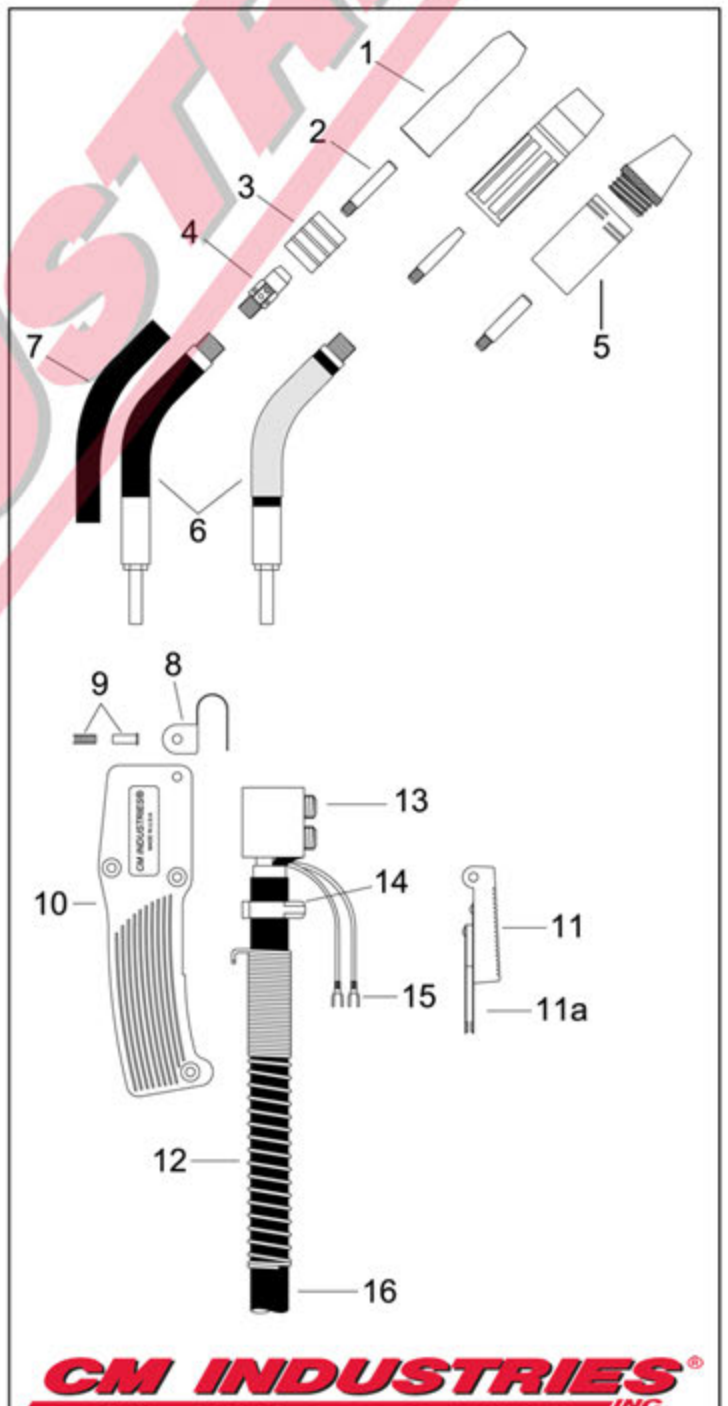

**CM INDUSTRIES**  
INC.

COPYRIGHT © 2010 CM INDUSTRIES, INC. ALL RIGHTS RESERVED

#	Part Number	Description
6.	C64A-45 C64A-60 C64A-80 C64A-180	Conductor Tube, 45° Conductor Tube, 60° Conductor Tube, 80° Conductor Tube, 180°
7.	C74A	Neoprene Insulation
8.	C152	Gun Hanger
9.	C122FM	Binder Screw & Post
10.	C84A	Handle
11.	C92	Trigger Switch Assembly
11a.	C92C	Replacement Trigger Blades
12.	C144-6S	Cable Support Spring
13.	C104	Cable Connector Block Assembly
14.	C134-16	Power Cable Clamp
15.	C244	Control Wire Terminal
16.	C400-10 C400-12 C400-15 C400-20 C400-25	Power Cable, 10' Power Cable, 12' Power Cable, 15' Power Cable, 20' Power Cable, 25'
17.	C350R-230-10S	Cable Support Spring
18.	C104	Cable Connector Block Assembly
19.	CM170-4H	Connector Plug Adaptor
20.	CM6RC	Round Connector Case
21.	C350-174H	Gun Plug, Tweco
22.	C224	O-Ring
23.	C44C	Set Screw
24.	C350-174MH	Gun Plug, Miller
25.	C174M-N	Conduit Nut, Miller
26.	C350-174LH	Gun Plug, Lincoln
27.	CMSAK-354	Electrical Plug, Miller
28.	CLAK-354	Electrical Plug, Lincoln
29.	C400-10E C400-12E C400-15E C400-20E C400-25E	Euro Power Cable, 10' Euro Power Cable, 12' Euro Power Cable, 15' Euro Power Cable, 20' Euro Power Cable, 25'
30.	185-40-001	Cable Support Spring Adaptor
31.	260-25-002	Adaptor Support, Euro
32.	285-01-001	Adaptor Support Screw
33.	290-01-012	Hex Nut, M12
34.	300-05-010	Male Terminal
35.	C174X-2	Adaptor Nut
36.	C174EX-1	Euro-Kwik Adaptor Assembly
37.	C174EX-1G	O-Ring, Euro
38.	C174EX-1C	Conduit Nut, Euro-Kwik
39.	C44-3545-15 C44-3545-25	Liner Assembly, 15', .035"-.045", Std. Liner Assembly, 25', .035"-.045"
	C44-116-15 C44-116-25	Liner Assembly, 15', .062" Liner Assembly, 25', .062"
	C44-564-15 C44-564-25	Liner Assembly, 15', 5/64" Liner Assembly, 25', 5/64"
	C44N-3545-15 C44N-116-15	Nylon Liner Assembly, 15', .035"-.045" Nylon Liner Assembly, 15', .062"

