

5260 Series Regulator

Single Stage

*Chrome-Plated
Forged Brass Body*

*316L Stainless Steel
Diaphragm*

*Liquid Cylinder or
Line Use*



Advanced Features

- *Designed for low inlet pressures*
Optimized flow with liquid cylinders
- *Large capsule® seat*
Permits flow rates unobtainable with conventional regulators
- *3000 PSIG Inlet pressure rating*
Safe for use with high pressure cylinders
- *Field Adjustable Pressure Limit*
Safeguard downstream equipment
- *Convolutioned Diaphragm*
Smooth pressure changes
- *Standard Relief Valve*
Diaphragm and gauge protection

The 5260 Series regulators are designed specifically for primary pressure control of assist gases supplied from cryogenic liquid cylinders for use in medium flow (up to 1500 scfh) and medium pressure (up to 200 PSIG) applications. The line version can be used in piping systems for lasing.

Applications

Laser Assist Gases from Liquid Cylinders
Nitrogen and Oxygen from liquid cylinders with flows up to 1500 scfh
325 or 500 PSIG cylinder heads

Laser Assist Gases from Pipeline
Nitrogen and Oxygen

Materials

Body
Chrome-plated forged brass

Bonnet
Chrome-plated die cast zinc

Seat
PTFE Teflon®

Filter
10 micron sintered bronze

Diaphragm
316L Stainless Steel

Internal Seals
PTFE Teflon®

Specifications

Maximum Inlet Pressure
3000 PSIG (210 BAR)

Temperature Range
-40 to 140°F (-40 to 60°C)

Gauges (PSI/BAR)
2 1/2" diameter dual scale brass

Ports
1/4" FPT

Helium Leak Integrity
1 x10⁻⁸ scc/sec

Cv
0.28

Weight
2.28 lbs. (1.26 kg)

Flow Performance Curves

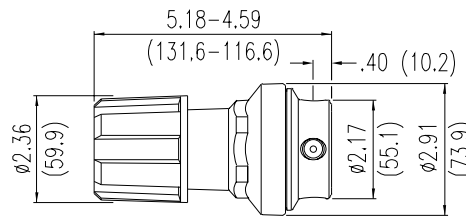
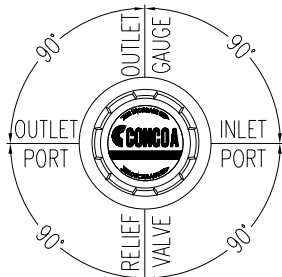
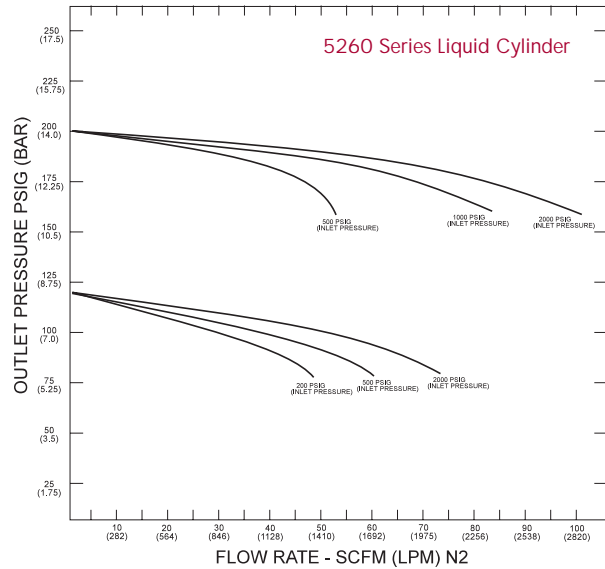
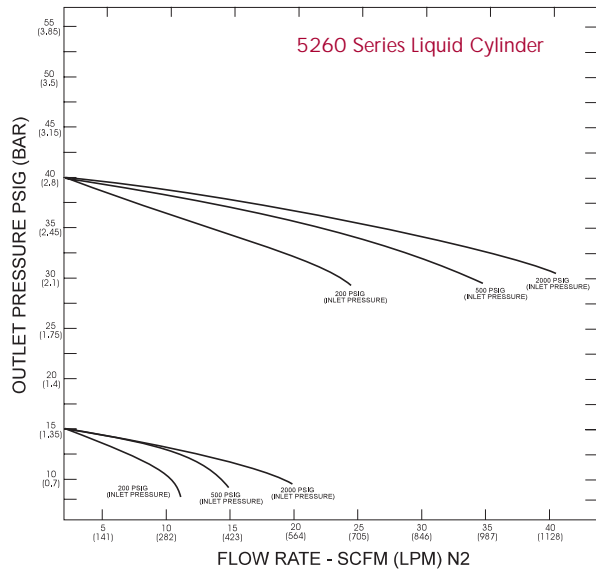

Ordering Information

Series	Part Number	Inlet CGA	Delivery Pressure	Gas Service	Outlet
5260 Liquid Cylinder	1806-5265	CGA 580	0-200 PSI (0-14 BAR)	Inert Gases (Nitrogen, Argon & Helium) Oxygen Carbon Dioxide	¼" Tube Stainless Steel compression fitting
	1806-5266	CGA 540	0-200 PSI (0-14 BAR)		
	1806-5261	CGA 320	0-200 PSI (0-14 BAR)		
5260 Line Use	1806-5260	¼" Tube	0-200 PSI (0-14 BAR)	Any Non-Corrosive Gas Any Non-Corrosive Gas	
	1806-5262	¼" Tube	0-120 PSI (0-8 BAR)		

Related Options

Option	Order No.	Description
Laser Gas Stations	See Page 24	Convenient regulator wall mount, including tee, bracket and flexible stainless steel pigtail with check valve in the inlet gland (Check valve not available on CGA 680 inlet models)
Laser Panels	See Page 25	Three Gas Panel delivery systems for the Laser Gases (Helium, Nitrogen and Carbon Dioxide) Tee and Straight Purge configurations to satisfy all requirements
Purge Devices	See Page 44	